

**Gujarat State Project Management Unit (SPMU) – ICZM Project
Gujarat Ecology Commission, Gandhinagar**

**NATIONAL COMPETITIVE BID FOR PROVIDING & CONSTRUCTION OF SEWER COLLECTION PIPELINE
NETWORK IN OUT GROWTH /NEW MERGED AREA IN THE CITY OF JAMNAGAR UNDER ICZM
PROJECT, GUJARAT.**

BID No: NCB/ICZMP/JMC/03/2016-17

Corrigendum No. 1

Date: 03/03/2017

The following amendments to the bid document are issued. The amendments will form an integral part of the bid document and the subsequent contract to be awarded to the successful bidder. The bidders are required to sign, authenticate and return this corrigendum along with the bid at the time of submission.

A. Technical

Sr. No	Reference Page/ Point No.	Original Provision as per Bid Document	Provision after Amendment
1.	Section -5 specification Page-72-128	12 CONTRACTOR'S SCOPE OF WORK: 12.1.1 River Sewer line /Interceptor Pipe line along River Rangmati: Providing, supplying, laying of NP4 class RCC (S& S) pipe of various diameters (as per BOQ) along the banks of River Rangmati starting adjacent to fort wall near Kalawad gate pumping station and connection to the Manhole near Navagam Main Sewage Pumping station.. The work includes construction of RCC manholes, masonry manholes, laying of pipes, jointing, encasing of pipe lines with concrete, sewer interceptor chamber with screens, testing, backfilling, consolidation and removal of excess earth and making the area level.etc.	12 CONTRACTOR'S SCOPE OF WORK: 12.1.1 SEWER COLLECTION PIPELINE NETWORK IN OUT GROWTH /NEW MERGED AREA IN THE CITY OF JAMANAGAR: Providing, supplying, laying of NP4 class RCC (S& S) pipe of various diameters (as per BOQ) For increase /decrease of any item to any extent, the bidder shall be paid at the approved rate of the particular item of the bid. And this work may be done at different locations within Jamnagar city limit (Incl. outgrowth / newly merged area in Jamnagar city). The work includes construction of masonry manholes, laying of pipes, jointing, encasing of pipe lines with concrete, sewer interceptor chamber, testing, backfilling, consolidation and removal of excess earth and making the area level.etc.
2.	Section- 6 Drawings page 129 –132	Three drawings on page 129 – 132 deleted	Now as per annexure -1 attached

Annexure-1

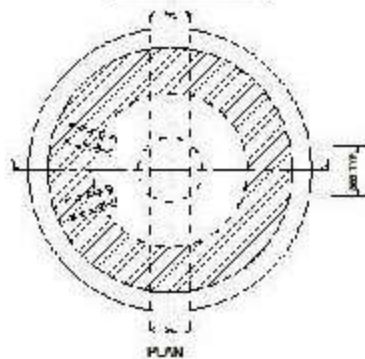
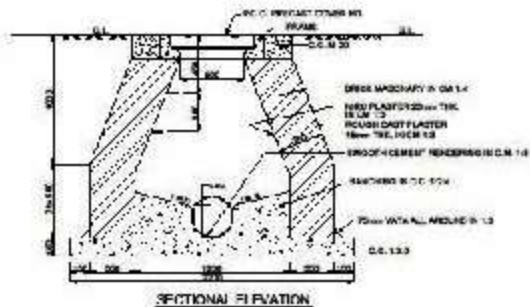

MANHOLE TYPE - A (CIRCLE AR)
DEPTH UP TO 1.8 mt. & PIPE D.A. 150 - 600 mm.

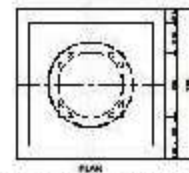
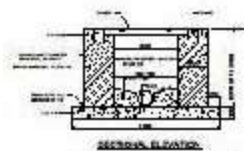

HOUSE CONNECTION CHAMBER

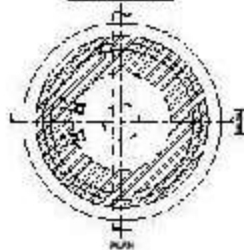
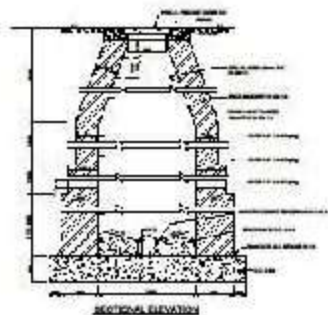

DETAILS OF MAN-HOLE TYPE-01 (CIRCULAR)
DEPTH ABOVE 6.3m & LP TO 10.8m. FOR MFD ØA.150-300 mm.

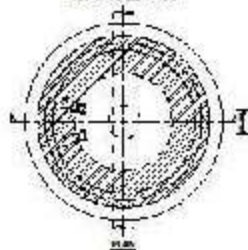
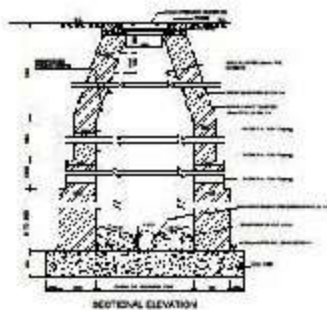

DETAILS OF MAN-HOLE TYPE-02 (CIRCULAR)
DEPTH ABOVE 6.3m & LP TO 10.8m. FOR MFD ØA.300-1000 mm.

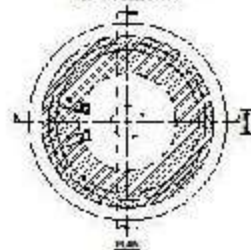
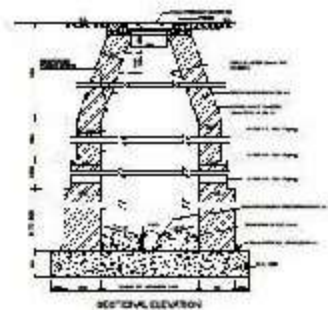

DETAILS OF MAN-HOLE TYPE-03 (CIRCULAR)
DEPTH ABOVE 6.3m & LP TO 10.8m. FOR MFD ØA.1100-1800 mm.

JAINAGAR MUNICIPAL CORPORATION

Dwg-3/5

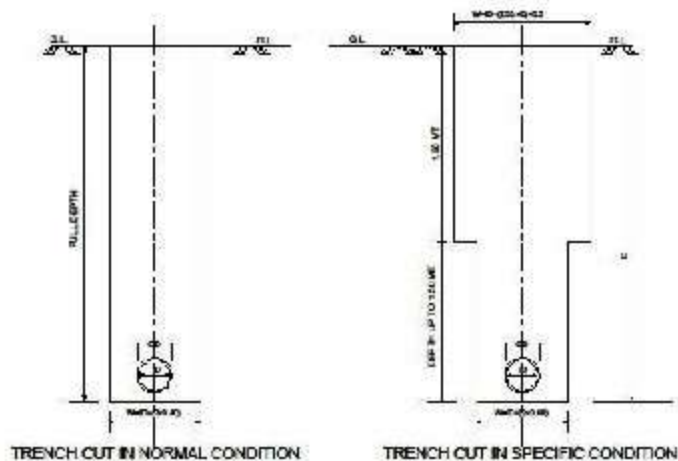

STATEMENT SHOWING THE STANDARD WIDTH FOR EXCAVATION OF TRENCHES IN NORMAL CONDITION

DIAMETER OF PIPE (MM)	STANDARD WIDTH (MM)
100	300
150	400
200	500
250	600
300	700
350	800
400	900
450	1000
500	1100
550	1200
600	1300
650	1400
700	1500
750	1600
800	1700

DIAMETER OF PIPE (MM)	STANDARD WIDTH (MM)
100	150
150	200
200	250
250	300
300	350
350	400
400	450
450	500
500	550
550	600
600	650
650	700
700	750
750	800
800	850

JMC U/G SEWERAGE SYSTEM

DETAILS OF STANDARD WIDTH FOR EXCAVATION OF TRENCHES

Dwg-4/5

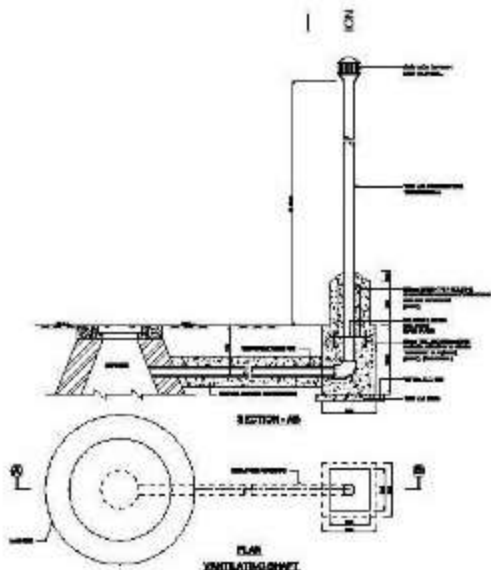
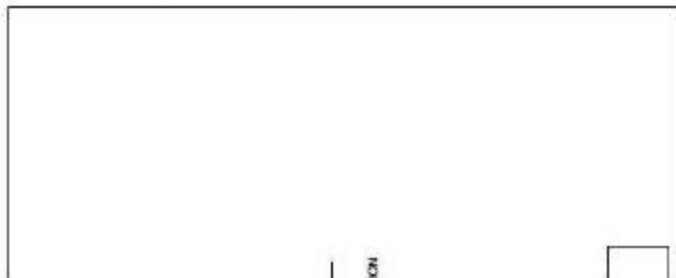

DETAIL OF WELD JOINT

NOTES:

1. Mild Steel Vent Shaft shall be of 100mm dia & 10m height from Ground Level with CI ornamental Cap.
2. This Shaft be Fixed Floorly and Crossed by G.C. 1200 with Necessary M.S. Sill, N.L. Plate etc for foundation.
3. The Vent Shaft shall be Painted with one Coat of Grey Paint Over One Coat of Lead Oxide Paint.
4. The Vent Shaft shall be Connected to Manhole by 100mm dia. Stone Ware Pipe crossed by G.C. 1200 of 150mm thickness at all around.