

Corrigendum-1 to NCB of

Construction Work of Rain Water Harvesting System including Rainy Water Filter and 5000 Itr Capacity Storage Tank UNDER Smart Eco Village Project - ICZMP

Bill of Quantities updated

Item No. & Description	Quantity	Rate	Per	Amount
Item No. 1				
Excavation for foundation upto 1.5 m depth including sorting out and stacking of useful materials and disposing off the excavated stuff upto 50 Meter lead.up to All Starta				
	3.28		Cumt.	
Item No. 2				
Excavation for foundation upto 1.5 m depth including sorting out and stacking of useful materials and disposing off the excavated stuff upto 50 Meter lead.(E) Hard Rock				
	3.28		Cumt.	
Item No. 3				
Excavation for foundation for depth from 1.5 m to 3.0 m including sorting out and stacking of useful materials and disposing off the excavated stuff upto 50 Meter lead.(E) Hard Rock				
	3.28		Cumt.	
Item No. 4				
Excavation for foundation for depth from 1.5 m to 3.0 m including sorting out and stacking of useful materials and disposing off the excavated stuff upto 50 Meter lead.(E) Hard Rock				
	2.95		Cumt.	
Item No. 5				
Providing and laying cement concrete 1:3:6 (1 cement : 3 coarse sand : 6 Machine cut stone aggregate 40mm nominal size) and curing complete excluding cost of formwork in (a) Foundation and plinth				
	0.66		Cumt.	
Item No. 6				
Providing & Laying controlled cement concrete M-250 and curing complete Including the cost of formwork and excluding the cost of reinforcement for reinforced concrete work in Top Slab (C) Slabs, Landings, Shelves, Balconies, Lintel, Beams, Girders and Cantilever upto floor two level. G.F.				
	0.77		Cumt.	
Item No. 7				
Providing & Laying controlled cement concrete M-250 and curing complete Including the cost of formwork and excluding the cost of reinforcement for reinforced concrete work in Raft Slab (C) Slabs, Landings, Shelves, Balconies, Lintel, Beams, Girders and Cantilever upto floor two level. G.F.				
	0.77		Cumt.	
Item No. 8				
Providing TMT/CRS-FE 500 Bar reinforcement for R.C.C. work including bending, binding and placing in position complete upto floor two level				

	91.94		Kg.	
Item No. 9				
White stone bela masoanry block in course in superstructure with stone of approved quality in cement mortar 1:5 (1 cement: 5 coarse sand) including racking the joints etc. complete.				
	2.89		Cumt.	
Item No. 10				
Providing and fixing C.I. Manhole cover 0.60m x 0.45m size having weight not less than 35 kgs. Including Providing CI Step 4 Nos. for UG Tank				
	2.00		Nos.	
Item No. 11				
Providing 20mm thick cement plaster in single coat on Rough (Similar)side of single or half brick walls for interior plastering upto floor two level and finished even and smooth in (iii) Cement mortar 1:6 (1-cement:6-sand)				
	40.38		Sqmt	
Item No. 12				
Providing & Supplying of Roof Top Rain Water Harvesting Filter using SS material of filternet inside of 3 -4 Inch Dia. Capacity 225 LPM for 1500-2400 Sqft Area of Roof, Harvesting Filter is its capacity to take up the load up to 10 to 225 square meters of roof area with variable intensity of rainfall of 5 to 75 mm/hour with a discharge capacity of 10 to 225 liters per minute.. Filter inlet and outlet connections can be rotated 360 degrees to suit to the pipe line directions per requirement and instruction given by engineer in charge. Bypass valve is provided with the filter to divert the sudden summer rains into the drain. Filter element is made out of SS-304 Steel and it is food grade The Filter being wall mounting can be fitted with wall bracket and flexible rubber straps with hooks. Inlet, outlet and drain outlets can be connected easily through the rubber bushes and bellows to the existing pipes. Including cost of Stop Water Valve for diversion of flow of first rain				
	1.00		No.	
Item No. 13				
Providing & Supplying of Domestic Cast Iron Hand Pump having Capacity of 15-30 LPH & suction capacity 20 feet. minn weight of pump should be 14 Kg. as per the requirement. Cost includes all king of materials, specials, Nut-Bolts and weather proof painting work as per the instruction given by engineer in charge. cost includes connecting pipe of 2-4 inch Dia GI pipe for suction with feeting work				
	1.00		No.	
Item No. 14 For Slab Roof or Flat Roof				
Providing and supplying and Fitting in standard length ISI mark rigid unplasticised PVC pipes suitable for Rain water with ring fit joint including cost of rings and specials and solutions etc all for fitting work as per IS specification no. 4985/1988 including all local and central taxes, transportation, freight charges, octroi, inspection charges, loading, unloading, conveyance to the departmental stores and including cost of jointing material etc. complete using MS clamps with distance of 450- 600 MM as per requirement including required "T" Bends and Elbows or any other specials required. Test Pressure 8 Kg/cm2. including cost of required valves minn. 4 Nos supply and fittings (75 - 90 MM Pipe as per requirement)				
	55.00		Rmt	
Item No. 14 (A) When Required For Sloopy Roof				
Providing and supplying including clamping, fixing etc as per instruction given by engineer in chrge for GI sheet Rain Water				

Harvesting Gutter using 5-6 mm Thick Sheet. Sheet should be powder coated and anti corrosive point. Using appropriate bolt, chapada, nuts etc asseccoroes. The Rate include all asseccories like MS angle, Flange, Pipe etc materials supply with redoxide paint, Black color Paint, Welding etc all. Rate for One running meter include all kind of materials supply and labour work for water drawing roof to tank for mangloori roof, slopy roof etc				
	55.00		Rmt	
Item No. 15				
Constructing Brick Masonary Chamber with brickwork using common burnt clay building bricks having crushing strength not less than 35Kg/Sq CM in foundation and plinth in Cement mortar 1:6.(B) Convetional with 15mm th.cement plaster in single coat on brick walls for internal plaster up to floor two level and finished even and smooth in cement mortar 1:4. with providing and laying 10 cm th. CC 1:3:6 and curing completed at the bottom of chamber excluding MH Frame and Cover of approved make . (Size 0.5 X 0.5 X 0.6)				
	1.00		No.	
Total Amount				

Approved Make List

PVC Pipe	GWSSB Approved Vendor Only
Hand Pump	ISI Approved Well known Brand
GI Sheet / Clamp	ISI Approved Well known Brand like Jindal or equivalent
TMT Bar / CRS	Electrotherm, Jindal, Gallent, etc approved brand by R & B Dept.
Cement	Sidhi, Hathi, Kamal, Ultratrack etc major plant cement approved by R & B / GWSSB
Etc Other Items	GWSSB / R & B Approved Vendor

General Specification finalized by R & B Department and Water supply department to be followed.

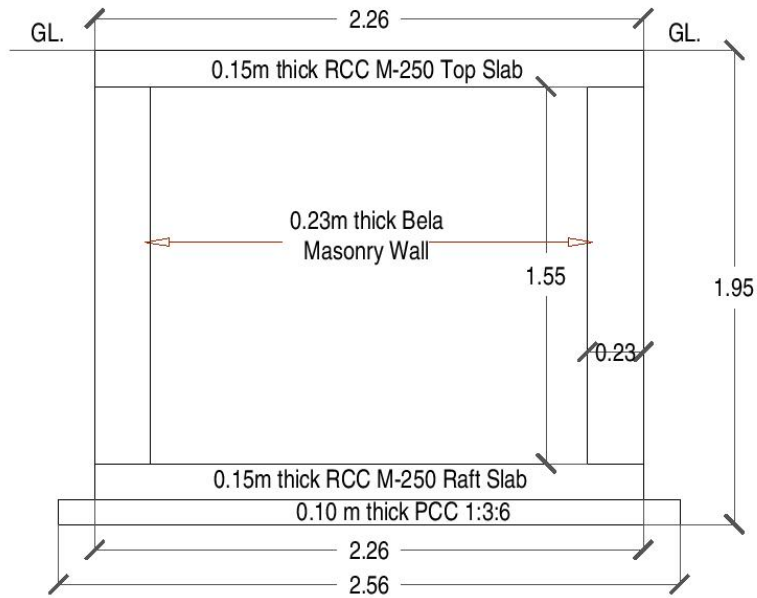

SECTION

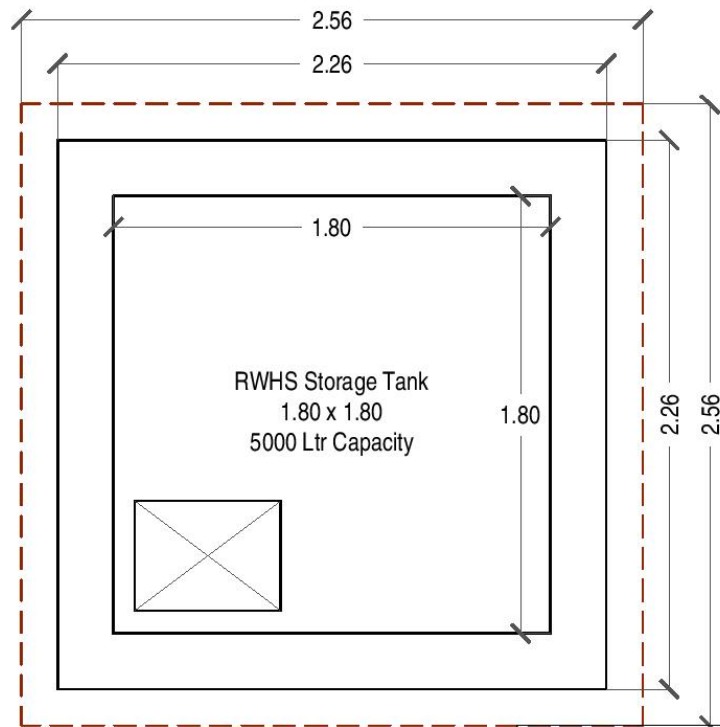

PLAN

Gujarat Ecology Commission
Smart Village Development Project
Cross Secion RWHS Storage Tank
Name of Authority : GEC-Gandhinagar

